



iCOCOON



Relaxation Chair

HCP-ICO10000A

HCP-ICO10000D

HCP-ICO10000E

Installation Manual

Thank you for purchasing the iCOCOON.

This is a high-end, furniture-style relaxation chair that combines design and medication with the goal of promoting mind and body health.

To those who conduct unpacking and installation work

This document explains the work to be carried out after carrying-in of the product for installation. To work safely and accurately, be sure to follow the steps in this document. The box containing this document also contains the objects shown below. Confirm that none of them are missing. After installing the product, keep this manual safe and available for future reference.

Check of bundled items

Confirm that the following items are contained in the package.

This product comes as two package boxes: one for the main unit & top panel and the other for the footrest and side panels (left and right).

Confirm that the main unit and bundled items are not damaged or broken.

1 / 2

Main unit
Top panel

Main unit

Top panel

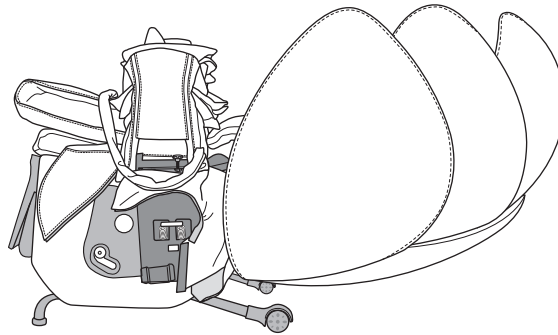

2 / 2

Footrest
Side panels

Footrest

Side panels × 2 (left and right)

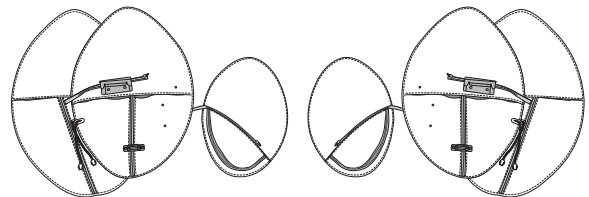
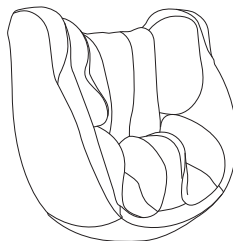

Bundled items

<p>Safety precautions</p>	<p>Monitor (stored under the back cushion)</p>	<p>T-shaped wrench</p>	<p>Power cable</p>	<p>Footrest mounting screw × 2</p>
<p>Footrest connection cover mounting screws × 1</p>	<p>Footrest connection cover × 1</p>	<p>Side panel mounting screw × 6</p>	<p>Caster stopper × 2</p>	<p>Moving strap</p>

Installation steps

Install this product by following the steps below.

1. Move the main unit to the installation site.
2. Mounting the footrest.
3. Mounting the top panel.
4. Mounting the side panels.
5. Attaching the monitor.
6. Connecting the power cable.
7. Turn on the power.
8. Place the caster stoppers.

- This product is heavy. Therefore, wear working gloves to prevent injury.
- Installation of this product must be carried out by two or more persons.
- When a product has been carried into a room from the cold outdoors, wait until the product has warmed up to room temperature (for one hour or longer) before starting the installation work.

Installation location

Checking installation location of the product

In order to prevent the product from making contact with a wall or other object, secure a clearance of 50 cm (19.7 inch) or more behind the product and a clearance of 50 cm (19.7 inch) or more in front of the product.

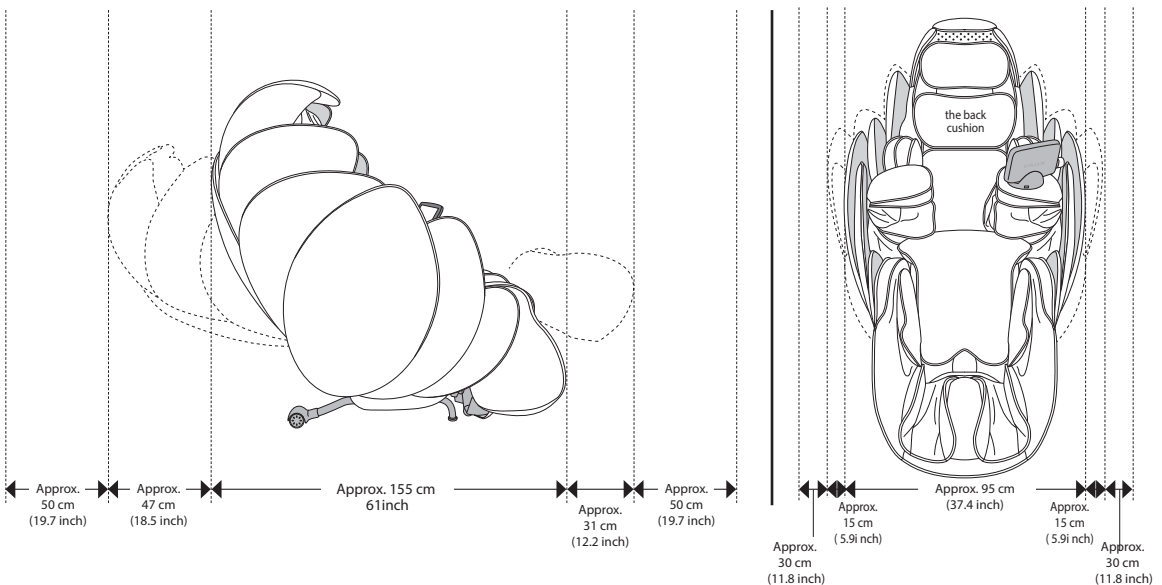

- To prevent the floor surface from being damaged and to reduce the sound made during work, place a mat or the like beneath the product. (Do not place a hot carpet.)
- This product is heavy. Therefore, pay attention not to damage the floor surface when putting down the product.
- Keep this product at least one meter away from AV devices such as a TV set or radio. Failure to follow this instruction may cause noise to interfere with the product.
- When person weighing 100kg (220 lbs.) sits on the product, a load of about 3.0kg/1cm² is applied to the floor surface when using the caster stoppers.



CAUTION

- Do not use this product in a humid location such as bath room or sauna.
- Install and use the product on a level floor surface.
- Do not use the product in a dusty location or a location with a high ambient temperature (40°C 104 ° F or higher).
- Do not install the product in a location subject to direct heat radiation, such as direct sunlight or a stove, that may heat the product to a high temperature.

How to carry in and relocate product

Relocating the product after its installation

When relocating the product, turn off the main power switch, disconnect the power plug from the receptacle, and also disconnect the connector of the power cable from the inlet.

The weight of the main unit is about 103 kg (227 lbs.). Therefore, move it very carefully.

The minimum dimension of the main unit is 69 cm (27.1 inch). (when using a moving strap.)

Remove the main unit and top panel from the box with the help of three people.

1 Move the box to the installation site

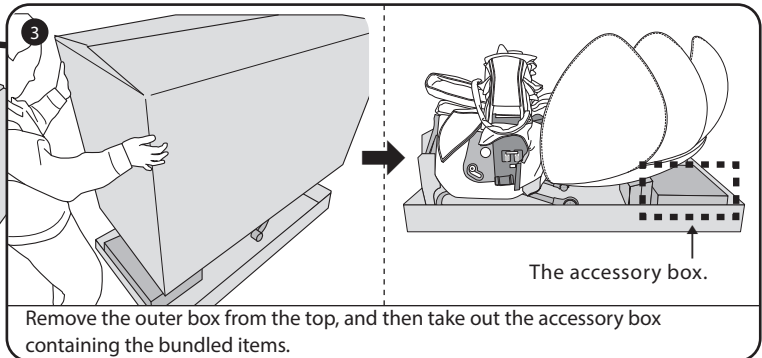
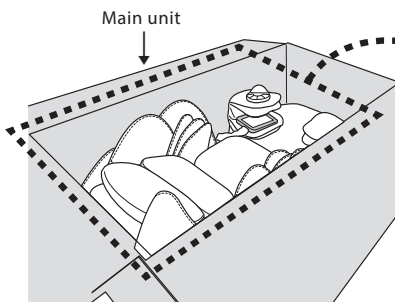
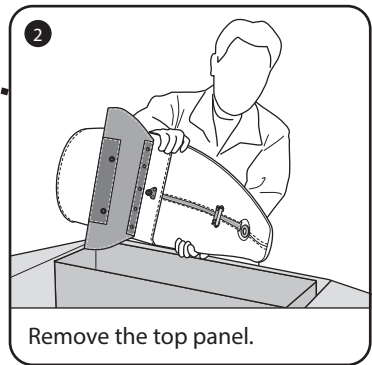
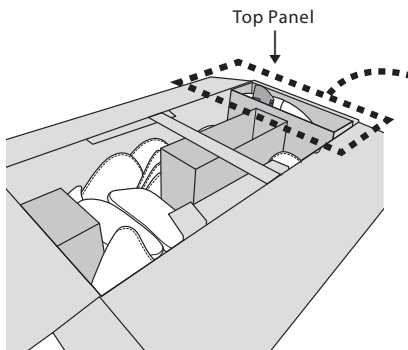
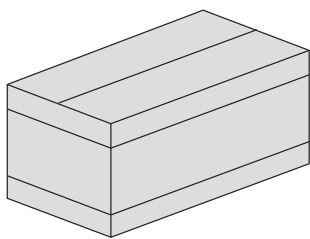

4 Wrap the moving straps around the side panels

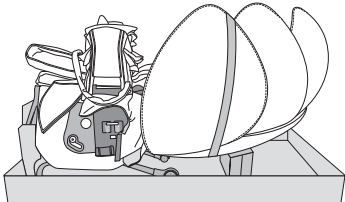

Before removing the main unit, wrap the moving strap around it while lifting the main unit from the outside of the side panels (see P11).

○ YES

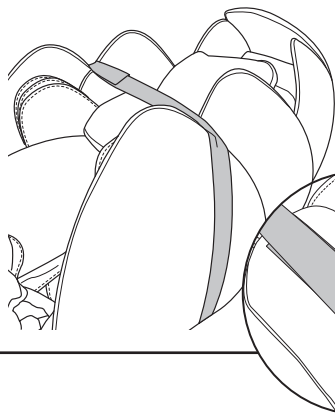

✗ NO

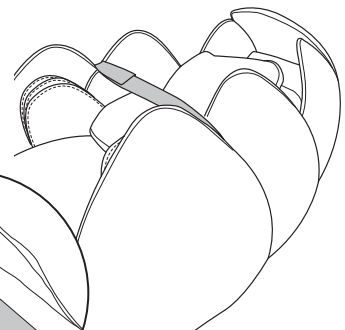

How to carry in and relocate product

5 Place the main body at the installation site

Move the main unit by holding the front leg part and handle near the speaker at the top part of the main unit.

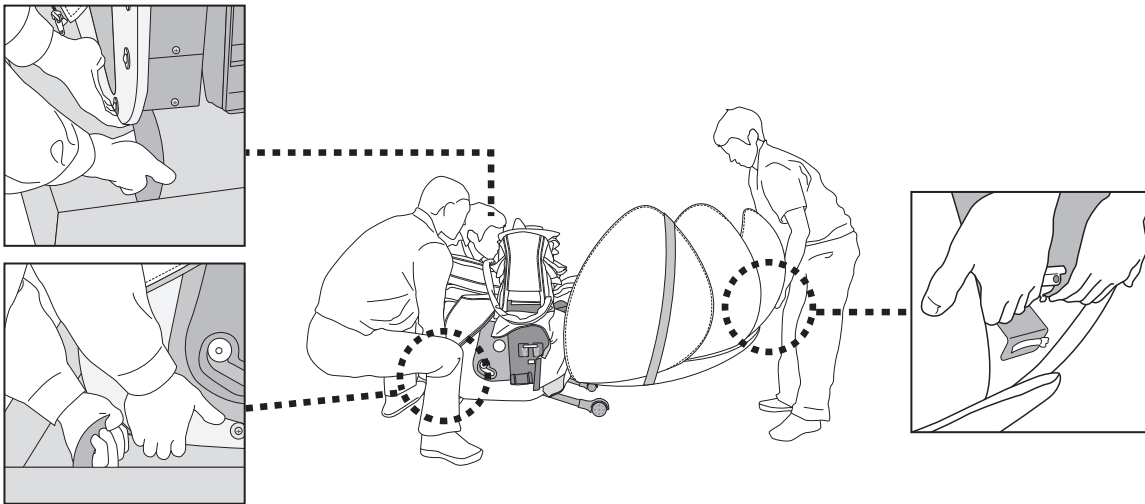

Carry the product using two people

Move the main unit by holding the front leg part and handle near the speaker at the top part of the main unit.

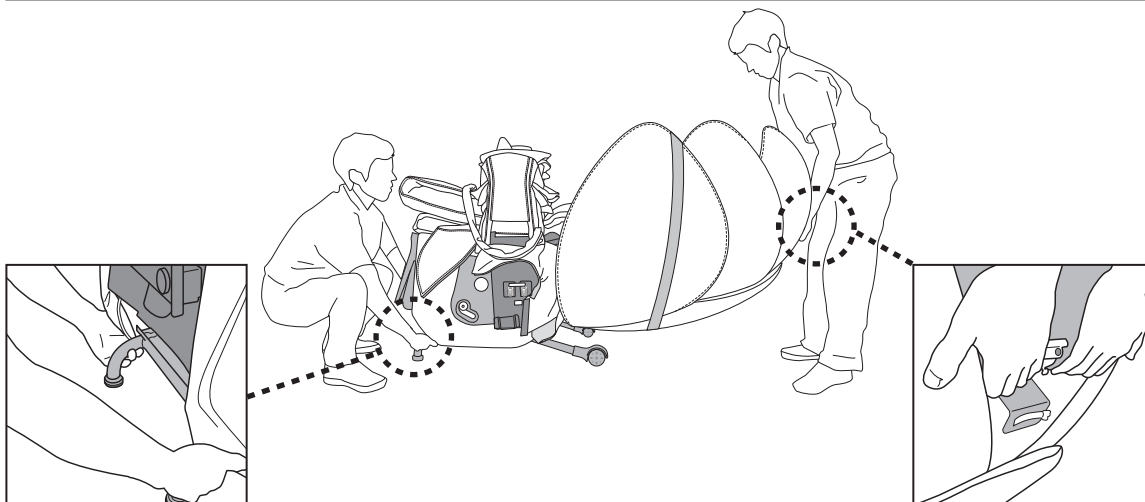

CAUTION

- Do not carry the product with a person sitting on it.
- Before carrying the product, disconnect the power cord from the receptacle, and disconnect the power cable connector from the inlet.
→ Failure to follow this instruction may damage the power cable, possibly causing fire or electric shock.

How to carry in and relocate product

When taking the stairs,

it should be done by three people

Move the main unit by holding the front leg part and handle near the speaker at the top part of the main unit.

To prevent the floor surface from being damaged and, place a mat or the like beneath the product.

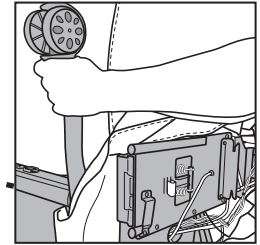
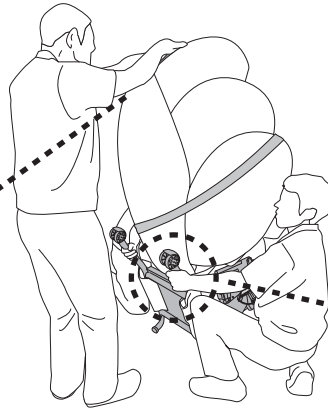
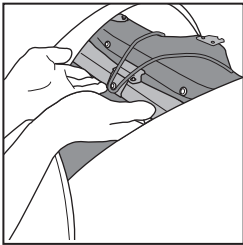

- The passage width should be more than 80 cm (31.4 inch) if not using moving strap and more than 70 cm (27.5 inch) if a moving strap is used.
- The minimum dimension of the main unit is 69 cm (27.1 inch). (when using a moving strap.)
- As the product is heavy, wear gloves for carrying so as not to drop the product or get injured.
- As the product is heavy, pay attention not to cause lower back pain during carrying in and transfer.
- Dropping the product may damage the floor or injure you. Therefore, securely hold the product.

Mounting footrest

Remove the footrest from the box

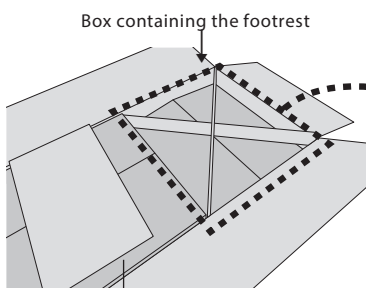

Box containing the side panels (left and right)

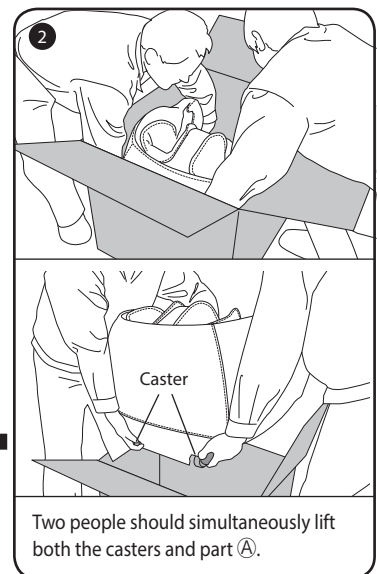
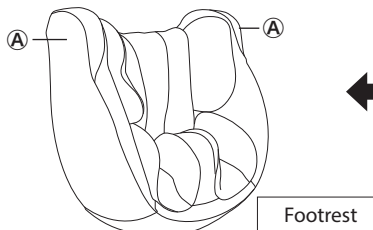
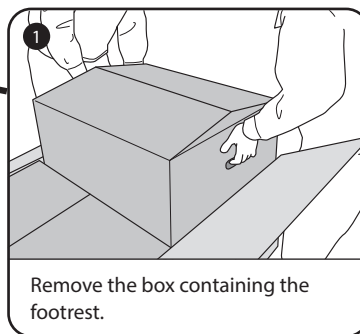

- The weight of the footrest is approx. 27 kg (59.5 lbs.).
- As the product is heavy, wear gloves for carrying so as not to drop the product or get injured.
- As the product is heavy, pay attention not to cause lower back pain during carrying in and transfer.
- Dropping this product may damage the floor or injure you. Therefore, securely hold the product.

Mounting footrest

Connecting the connector and air Hose

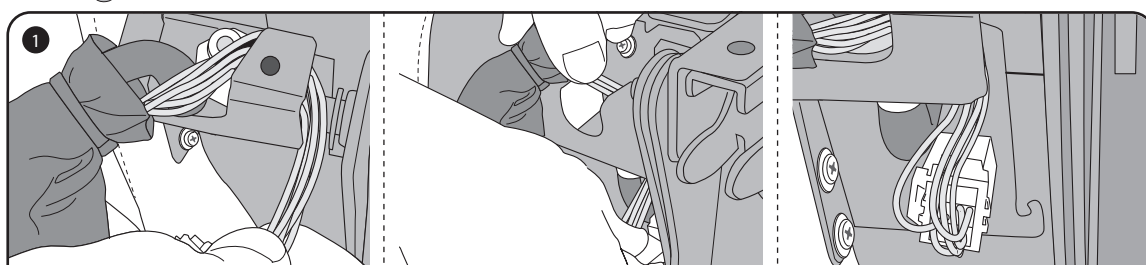
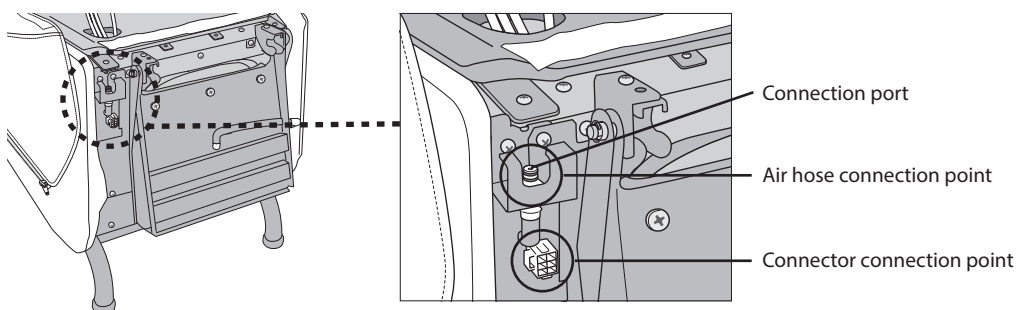

1 Insert the wiring of the connector on the footrest side into the back of the iron plate on the main unit side, and push it in until clicks into the place.

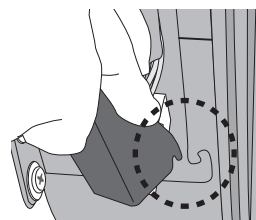
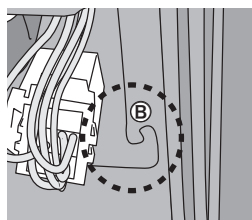
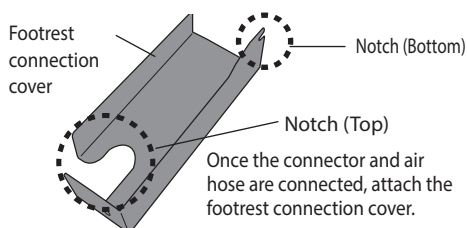

While setting the footrest connection cover, connect the air hose.

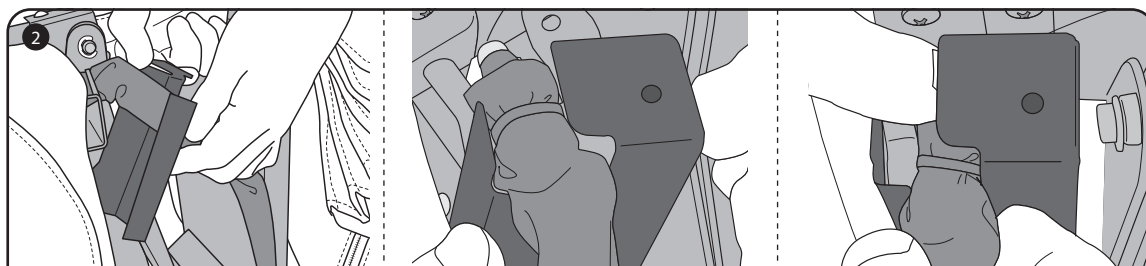

2 Pass the air hose through the notch (top) of the footrest connection cover from below. Hook the notch (bottom) of the footrest connection cover onto **B** on the main unit side, and push the tip of the air hose into the connection port by using your left index finger. Ensure the air hose is fully inserted.



- Before dismantling or mounting the footrest, confirm that the main power switch is turned "OFF", and then disconnect the power cable from the receptacle while also disconnecting the connector of the power cord from the inlet.
→ Failure to follow this instruction may damage the power cable, possibly causing fire or finger pinched.
- When dismantling and mounting the footrest, pay attention not to get your hand or finger pinched between the main unit and footrest.
- Positively insert the connector all the way to the back. Securely tighten the mounting screws as well.
→ Failure to follow this instruction may cause an accident, injury or malfunction to occur.

Mounting footrest

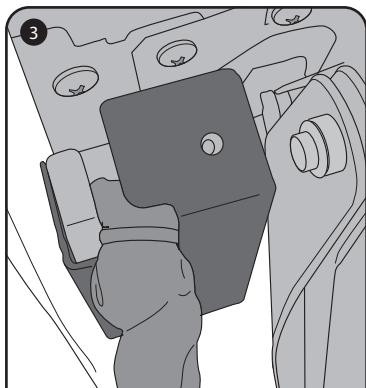

Align the screw holes of the footrest connection cover with those on the main unit.

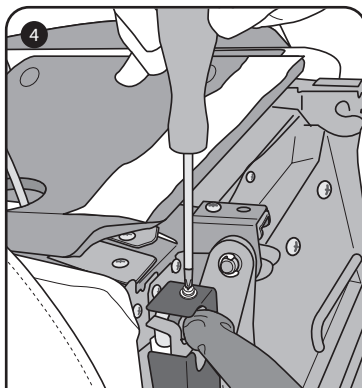

Use a Phillips screwdriver to tighten the screws on the footrest connection cover.



CAUTION

- Ensure that no wires are pinched when attaching the footrest connection cover.
- Ensure that the tip of the air hose is inserted into the connection joint.

Mounting the Footrest to the Main Body

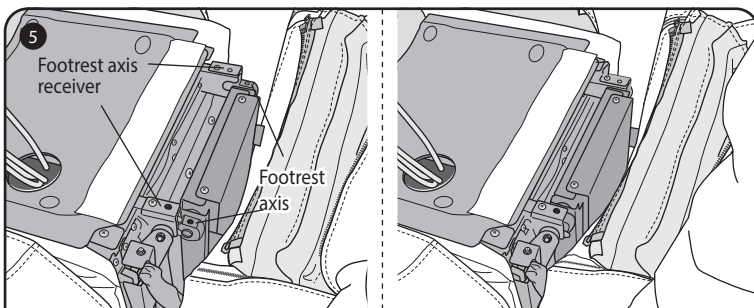

With the thread holes of the footrest axis facing upward, lift the footrest and set the footrest axis receivers of the main unit.

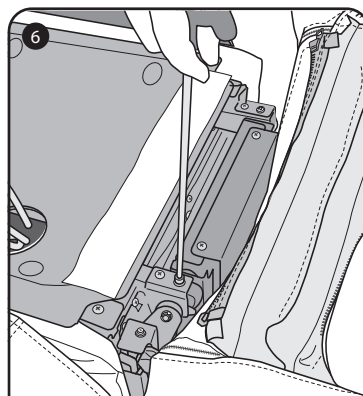

By using the supplied T-shaped wrench, securely fasten the footrest with the footrest mounting screws.

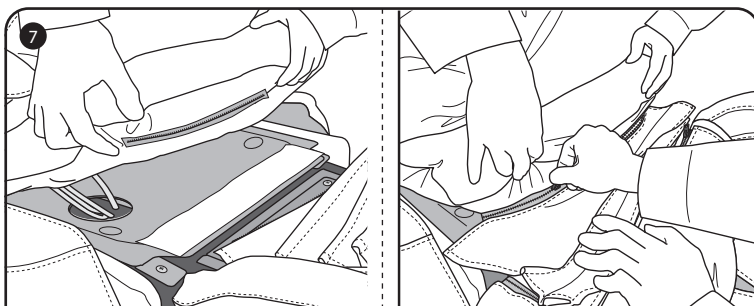

Lift the seat. Align the zipper at the upper end of the footrest cover with the main unit, and close the zipper.

Mounting footrest

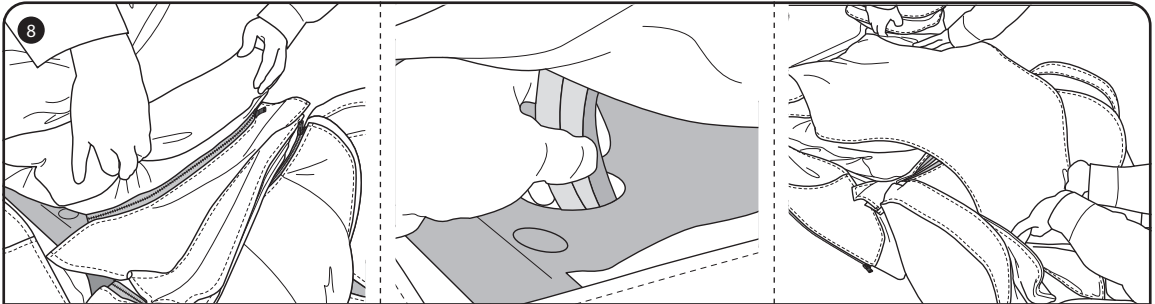

After closing the zipper, lower the seat cushion. Always ensure the air hose is properly dropped into the hole.

When dismantling the footrest, follow the above steps in the reverse order.

How to adjust the Legs

The height of only front legs can be adjusted on the left and right sides. The adjustable height is approx. 1 cm (0.4 inch). When adjusting, keep the front legs up and adjust the height. Be careful not to get your fingers caught when adjusting the chair height.

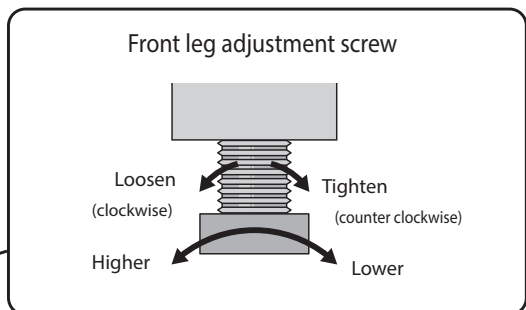
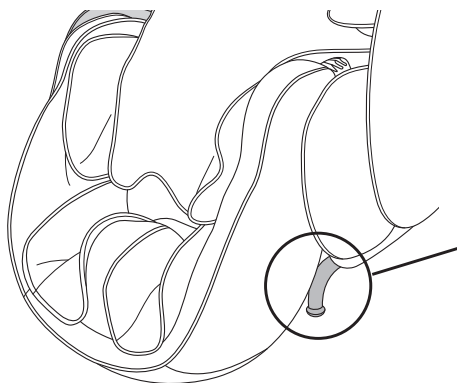

Mounting top panel

Mounting the top panel.

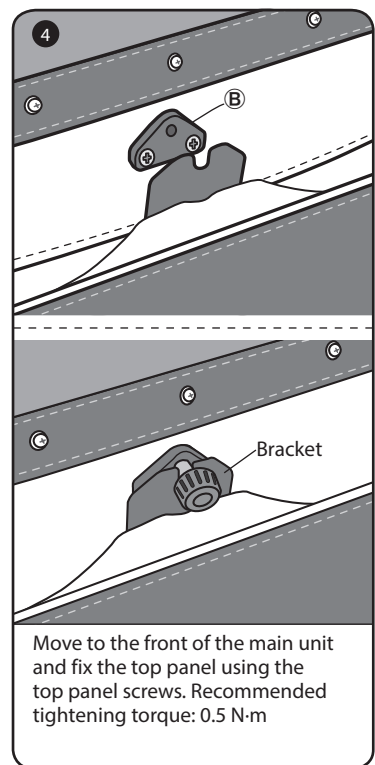
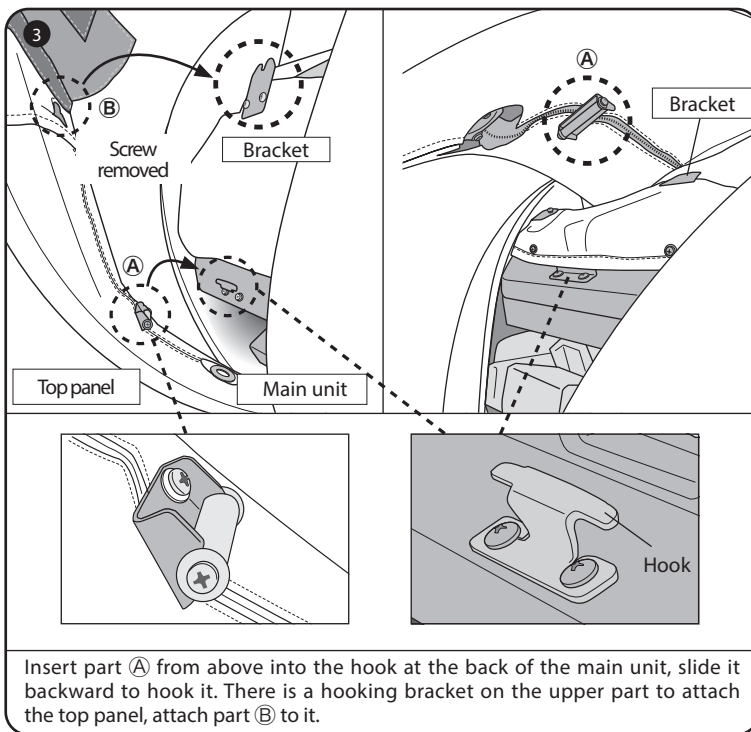
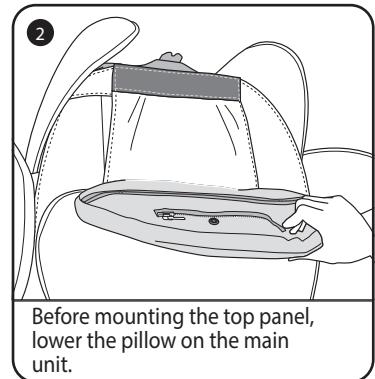
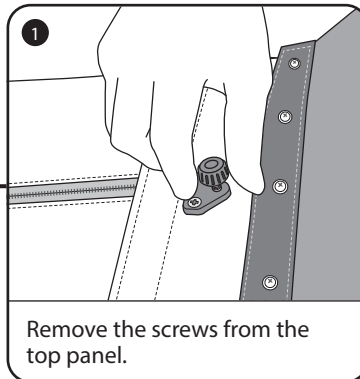
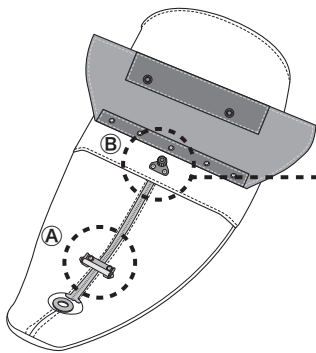

Mounting top panel

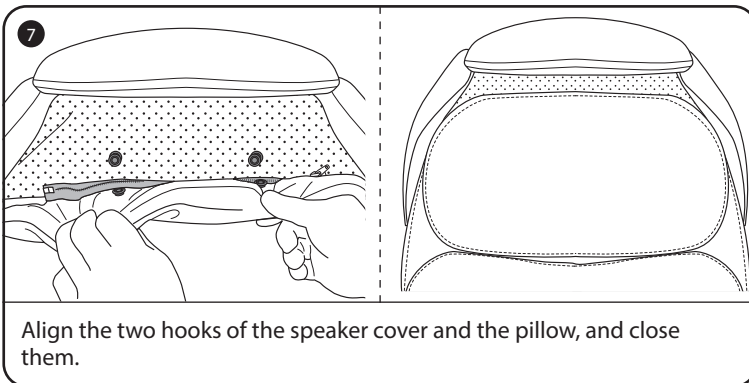
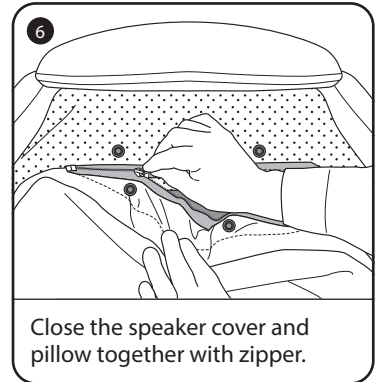
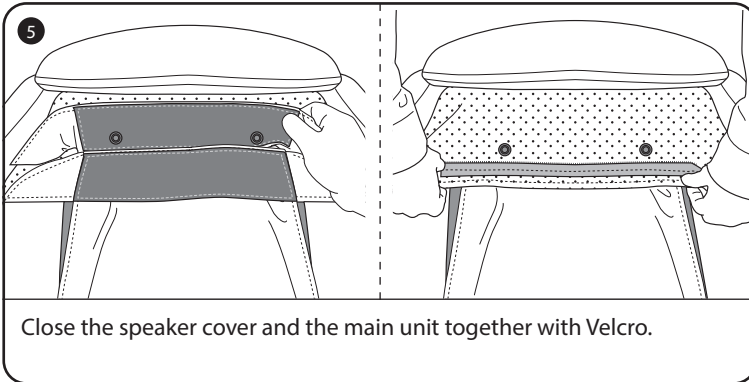

When dismantling the top panel, follow the above steps in the reverse order.



- Be careful not to drop screws when securing them with screws.

Mounting side panels

Names of Parts of the Side Panels

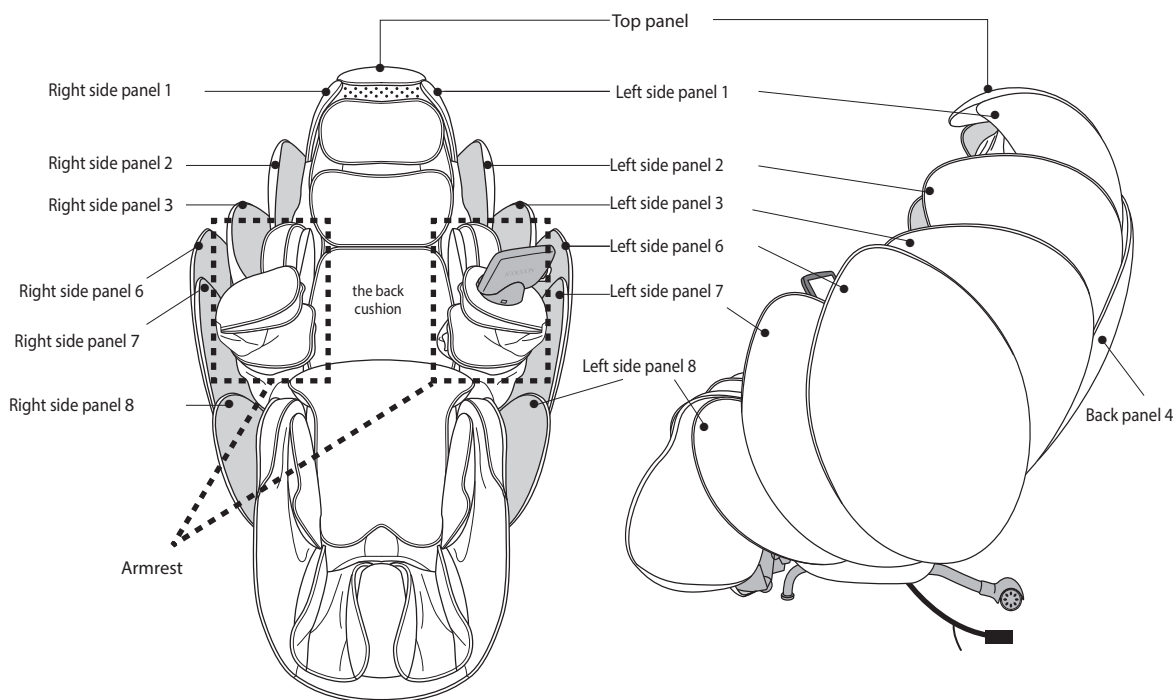

Remove the side panels from the box.

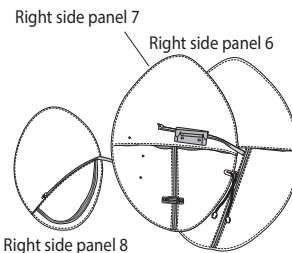
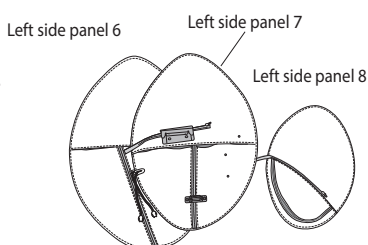
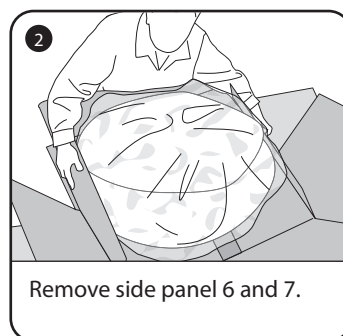
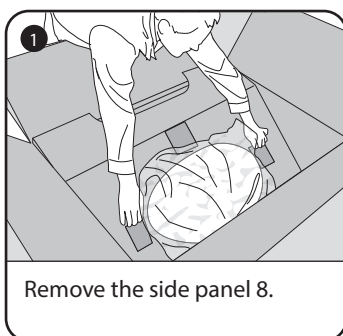
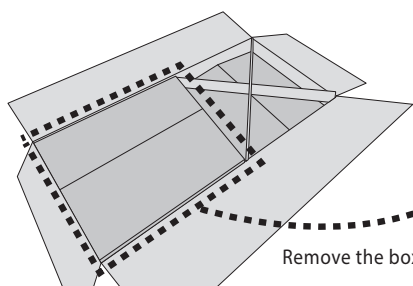

The box containing the side panels includes "Left Side Panel 6, Left Side Panel 7, Left Side Panel 8" and "Right Side Panel 6, Right Side Panel 7, Right Side Panel 8" each wrapped together in the box. Remove the wrap.



- Be careful when using the box cutter or scissors to avoid personal injury or scratch the surface of the panels.

Mounting side panels

Mounting the left side panels

1

Left side panel 6 Left side panel 7 Mounting hook bracket
 LED harness (small) LED harness (large)
 Mounting screw hole
 Left side panel 8 front Left side panel 8 back
 When opened
 Use 3 out of the 4 holes

Turn the left side panel 8 to the backside, open the zipper, and attach left side panel 8 to left side panel 6 and 7.

2

Align the holes (three places) in left side panel 7 with the holes (three places) in left side panel 8, and use your Phillips screwdriver to secure the side panel mounting screws. After securing, close the zipper on left side panel 8.

3

Side panel fixing screw
 Left side panel 7 Left side panel 6
 Left side panel 8

Remove the side panel fixing screws from the mounting bracket.

In the combined left side panels 6, 7 and 8, combine the LED harnesses coming out of left side panel 6 and left side panel 7 with LED harnesses coming out of the side of the unit.

Mounting side panels

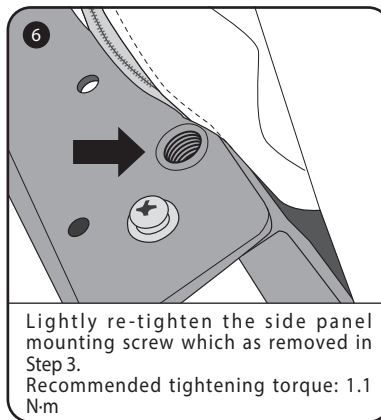
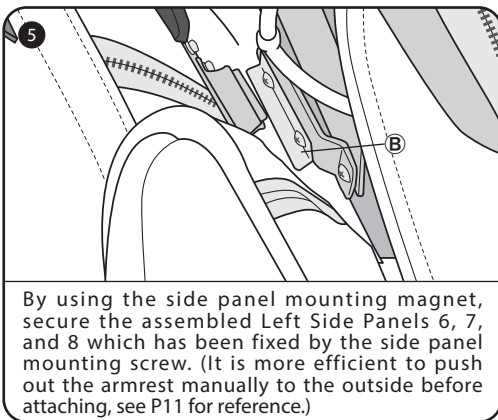
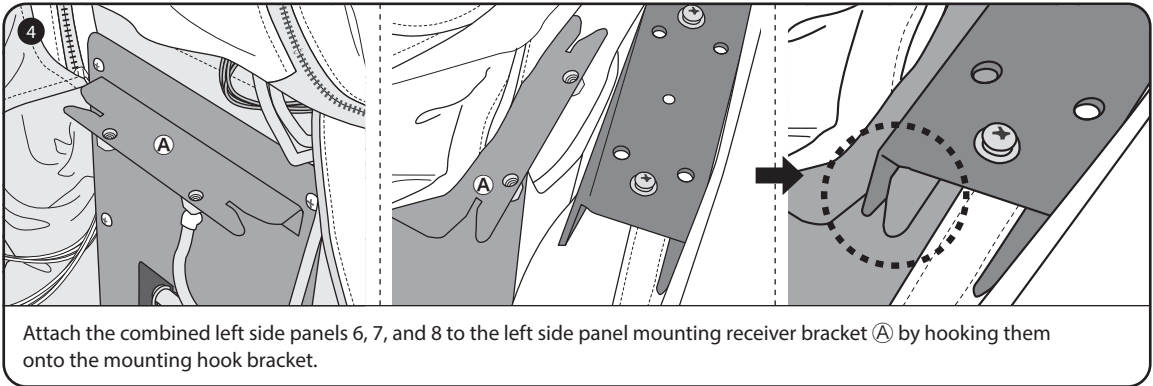
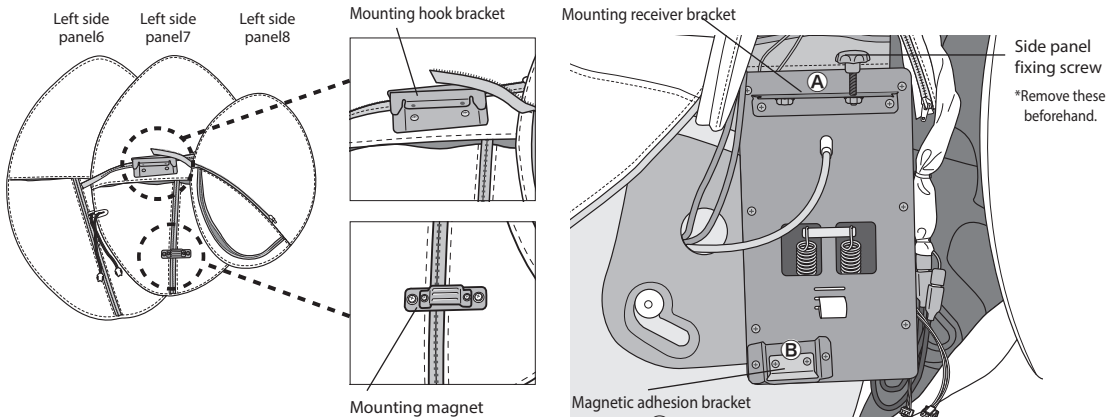



CAUTION

- Before dismantling or mounting the side panels, confirm that the main power switch is turned "OFF", and then disconnect the power cable from the receptacle, and also disconnect the connector of the power cable from the inlet.
→ Failure to follow this instruction may damage the power cable, possibly causing fire or electric shock.
- When dismantling and mounting the side panels, pay attention not to have your hand or finger pinched between the main unit and the armrest.
- During mounting work, positively insert the connector all the way to the back. Securely tighten the mounting screws as well.
→ Failure to follow this instruction may cause a failure.
- Wear work gloves to prevent injuries while at work.

Mounting side panels

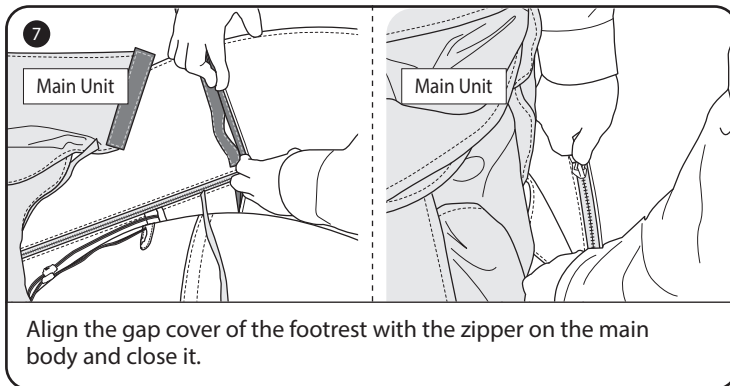

When dismantling the side panels, follow the above steps in the reverse order.

Mounting right side panel

Follow the same steps as for mounting the left side panel.

Attaching monitor

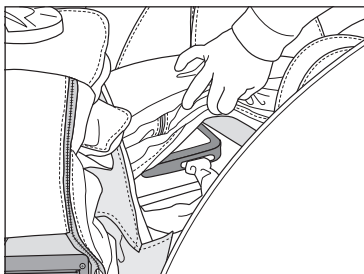

The remote control is located under the back cushion. Please remove it.

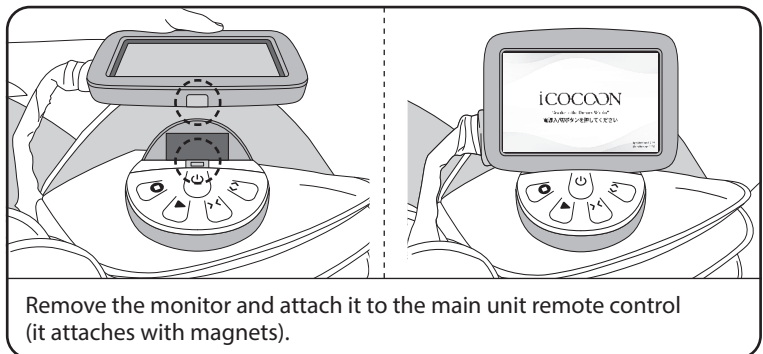

- Be careful not to drop the monitor when attaching or detaching it.
- Ensure the cable does not get caught in the side panel or other parts.

Connecting the power cable

- Be sure to use the power cable comes with this product.

Turning on the power

- ① Insert the connector of the power cable to the inlet located at the rear of the main unit, and insert the power plug to the receptacle.

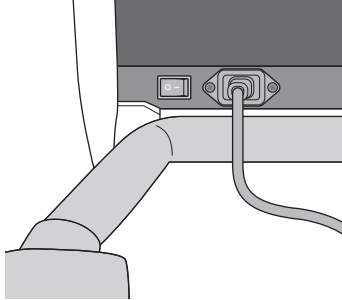

- ② Turn "ON" the main power switch located at the rear of the main unit. At this point, characters are displayed on the monitor, and the logo LED on the top panel will light up.

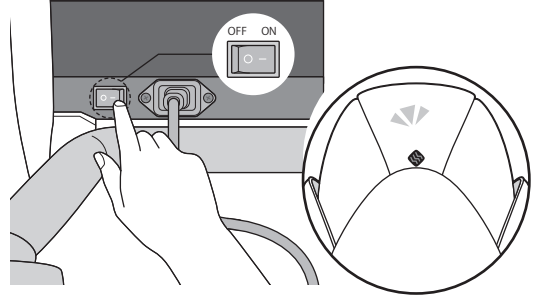

- It may take about one minute for the monitor screen to be displayed.
- *If the backrest is in a reclined state (or if the backrest is reclined, or the footrest is raised), the backrest will automatically return to its upright position.
- *If the mechanisms are stopped at intermediate position, turning "ON" the main power switch will cause them to move their housing positions and stop.
(back mechanism... lower part of the backrest, sole mechanism... open state).



Warning

- Do not use this product by using a transformer.
→ Failure to follow this instruction may cause a failure of this product or an electric shock.



CAUTION

- Before inserting the power plug to the receptacle, confirm that the main power switch is set to "OFF".
- Positively insert the power plug and the connector all the way to the back.

Placing the caster stopper

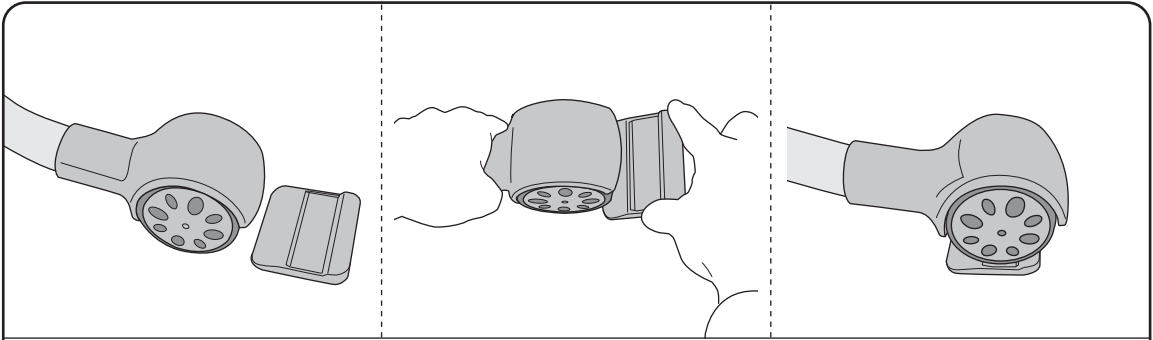



Place the caster stoppers, lift the front pipe of the caster slightly and push it in from the back.



- Placing and displacing the caster stoppers, make sure that the backrest is in the upright position.
- Be careful not to pinch your fingers during placing and displacing.

Points to check after installation

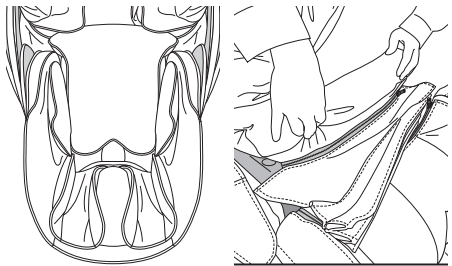
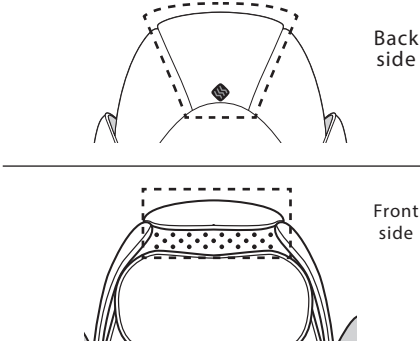
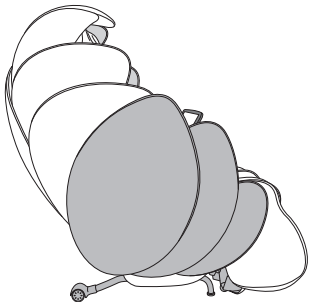
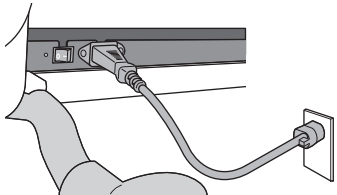
The following are the final check points to be checked after the unpacking and installation work. Check the check-boxes for the items you have checked.

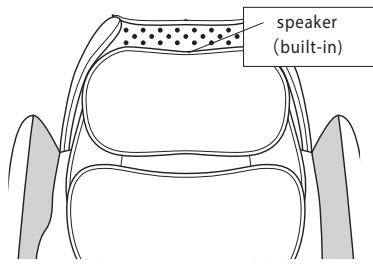
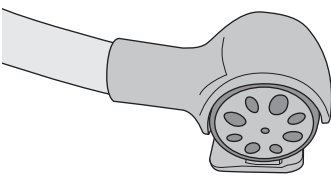
<p>1.Mounting of footrest</p>  <p>Confirm that the zipper is positively closed to the end.</p>	<p>Check</p> <p>Mounting <input type="checkbox"/></p> <p>Zipper <input type="checkbox"/></p>	<p>2.Mounting of top panel</p>  <p>Back side <input type="checkbox"/></p> <p>Front side <input type="checkbox"/></p>	<p>Check</p>
<p>3.Mounting of side panels</p> 	<p>Check</p> <p>Right <input type="checkbox"/></p> <p>Left <input type="checkbox"/></p>	<p>4.Insertion of the power cord</p>  <p>Confirm that the power cable is fully inserted into the inlet on the main unit.</p>	<p>Check</p>
<p>5.Attachment of monitor</p> 	<p>Check</p> <p>Stand <input type="checkbox"/></p> <p>Operation check <input type="checkbox"/></p>	<p>6.Speaker operation check (audio)</p>  <p>speaker (built-in)</p>	<p>Check</p> <p>Audio <input type="checkbox"/></p>
<p>7.Placing caster stoppers</p> 	<p>Check</p> <p><input type="checkbox"/></p>	<p>8.Check the bundled items after installation</p> <p>After installing the product, confirm that the following bundled items are present.</p> <p>Safety precautions <input type="checkbox"/></p> <p>T-shaped wrench <input type="checkbox"/></p>	

MEMO



<https://www.family-chair.co.jp>

Headquarters: 4-2-10 Miyahara, Yodogawa-ku, Osaka City, Osaka

Manufacturer/seller: Family Inada Co., Ltd. (Daisen Factory): 1220 Takata, Daisen-cho, Saihaku-gun, Tottori

*The product specifications (including tablet display design) may be subject to partial change for product improvement without prior notice.

DATE OF ISSUE (day/mo/yr) : 29/10/2024(first edition)